

Butterfly Valves

- Wafer type butterfly valve
- Lug type butterfly valve
- Reductors
- Actuators



Butterfly Valves

VTM butterfly valves are produced from DN 40 to DN 600 in Wafer and Lug types with superior technology. These butterfly valves can be used in HVAC, watering systems, petrochemical industry, medicine industry, food, ship, cement, leather, paper, paint industry, metallurgy, textile, energy, bioenergy, purification and also in general purpose usage whereas can be used in many processes that require flow control. VTM butterfly valves are more advantageous than most of the industrial valves, considering the factors of being economic, durable and convenience for (de)installation and maintenance.

Technical Features

- Body dimensions : IS 13095, EN 558-1, DIN 3202-K1, MSSP
- Flange drilling : Wafer type valves: ANSI class 125/150, Table D/E
PN6 / PN10 / PN16 for DN32 - DN300
ANSI class 125/150, PN10 for DN 350 - DN600
Lug type valves: PN16 for DN40 - DN300
PN10 for DN350 - DN600
- Top Flange : ISO 5211
- Test standard : IS 13095, , EN 12266 / API 598
- Max. operating pressure : 16 bar for DN32 - DN 300
10 bar for DN350 - DN 600
- Operation : Is used by 90 degrees movement of the control lever with reductor and/or pneumatic, hydraulic, electric actuators.

VTM Butterfly Valve Superior Features:

- Assembly and disassembly convenience
- Low pressure loss
- Full impermeability
- Long neck body design
- Low torsion moment, convenient performance
- Two pieced klappe design with shart to prevent pressure loss in minor sizes
- Ergonomic and lockable lever design
- Reductors fit every sizes
- Corrosion enduring, thick epoxy body plate.

Body and Shaft Options

Body	Shaft
GG 25 cast iron	AISI 416 stainless steel
GGG 40 sphero casting	AISI 304 stainless steel
AISI 304 stainless steel	AISI 316 stainless steel
AISI 316 stainless steel	

Disc options

Disc	Op. Temp	Area of usage
GGG 40 Nickel pit. sphero cast	-30...+350	Hot&Cold Water, Stern, Oils, Alcohol,
AISI 304 stainless steel	-268...+316	Hot&Cold Water, Stern, Oils, Alcohol, Food, Medicine, N. Gas, Acids
AISI 316 stainless steel	-268...+316	Hot&Cold Water, Stern, Oils, Alcohol, Food, Medicine, N. Gas, Acids
Aluminum-Bronze	-273...+232	Sea Water, Alcohol, Natural Gas, Oils

Seat Options

Seat	Op.Temp	Area of Usage
EPDM	- 50°C + 130°C	Hot&Cold water, Alkali Fluids, Alcohols, Air, Sea water, sugar industry, Ammoniac, High Ph acids, Diluted Acids,
NBR	-10°C + 100°C	Hydraulic Oils, Cold water, Sea Water, Fuels, Mineral Oils, Herbal Oils,Alcohol, High Ph acids, Non-Aromatic Hydrocarbons, Inert Gas, Diesel, Synthetic Thinner
NR	-10°C + 85°C	Cold water, Inert Gases, Paper, Medicine, Cement, Sand, Lime Powder
Viton	-25°C + 180°C	Gas, Flammable Gas, Animal and Mineral Fat, Mineral Acids, All Aromatics, Steam, Hot water, Petroleum Products, Alifatics, Halogenious Hydrocarbons, Ester, Detergent, Fuel
PTFE	-20°C + 230°C	Medicine Industry, Food Indutry, Chemical Process, Alkali Fluids, Acids, Distillation Industry, Alcohol
Silicon	-60° C + 200°C	High and Low temperature applications, strong base, hot water, steam applications

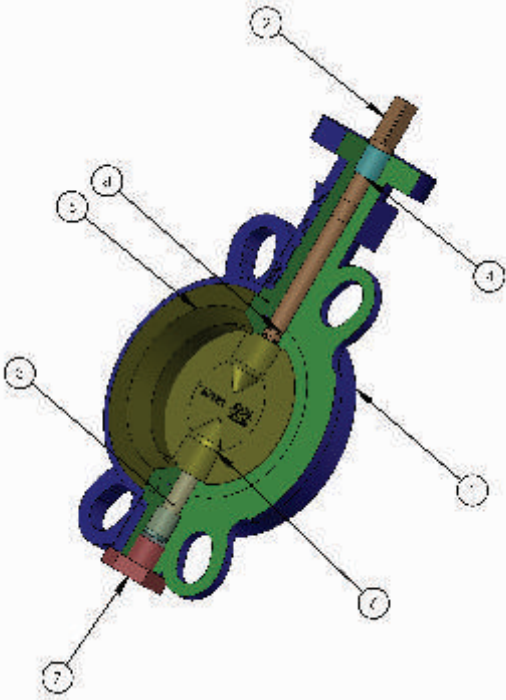

PART LIST

S.NO.	PART NAME	MATERIAL	SPECIFICATIONS	QTY.
1.	BODY	DUCTILE IRON/S.G. IRON	GGG40	1
2.	MAIN SHAFT	STAINLESS STEEL	AISI-304/316/410	1
3.	PIVOT SHAFT	STAINLESS STEEL	AISI-304-316/410	1
4.	BERING	PLASTICS	PTFE/NYLON	2
5.	LINER	RUBBER/ELASTOMER	NIT RILE/EPDM/VITON/PTFE	1
6.	DISC	STAINLESS STEEL/ S.G. IRON	ASTM A351CF8/CF8M/GGG40	1
7.	PLUG	S.G. IRON	GGG40	1
8.	O-RINGS	RUBBER/ELASTOMER	NIT RILE/EPDM/VITON/PTFE	4
9.	FASTNERS	CARBON STEEL/STAINLESS STEEL	---	---

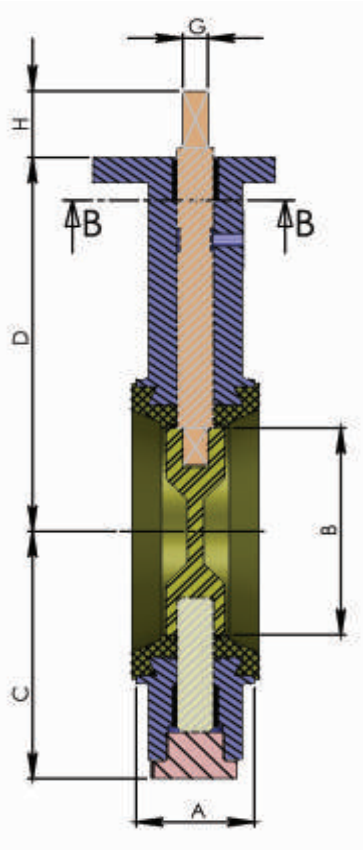

DESIGN STANDARD : BS 5155/API609/ISO5211

SIZE	INCH	A	B	C	D	E	F	G	H	M	N
DN32	1 1/4"	33	32	73	109	65	50	9.5	21	7.50	4
DN40	1 1/2"	33	40	73	109	65	50	9.5	21	7.50	4
DN50	2"	43	50	73	132	65	50	9.5	21	7.50	4
DN65	2 1/2"	46	66	81	141	65	50	9.5	21	7.50	4
DN80	3"	46	80	96	147	65	50	9.5	21	7.50	4
DN100	4"	52	101	108	172	90	70	11	22	9.50	4
DN125	5"	56	124	125	187	90	70	11	22	9.50	4
DN150	6"	56	150	131	201	90	70	11	22	9.50	4
DN200	8"	60	201	167	229	125	102	17	32	11	4
DN250	10"	68	251	202	268	125	102	20	32	11	4
DN300	12"	78	301	235	297	125	102	20	32	11	4
DN350	14"	78	340	278	330	125	102	22	24	11	4
DN400	16"	102	392	306	358	175	140	27	27	17.5	4
DN450	18"	114	442	357	403	175	140	36	40	17.5	4
DN500	20"	127	486	385	435	210	165	40	48	21	4
DN600	24"	154	591	456	510	210	165	40	49	21	4
DN750	30"	165	690	536	615	300	254	46	57	17	8

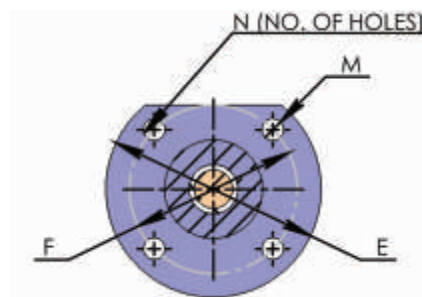

Butterfly valves operation alternatives

- A - Manual worm gear operation;
- A1 - Worm gears are suitable for all sizes
- B - Actuator operation;
- B1 - On-Off ve rational operated pneumatic actuator
Double action pneumatic actuators -
Single action pneumatic actuators
- B2 - On-Off ve rational operated electrical actuators
- B3 - Hydraulic actuators

Switch box - Solenoid valves - Positioners

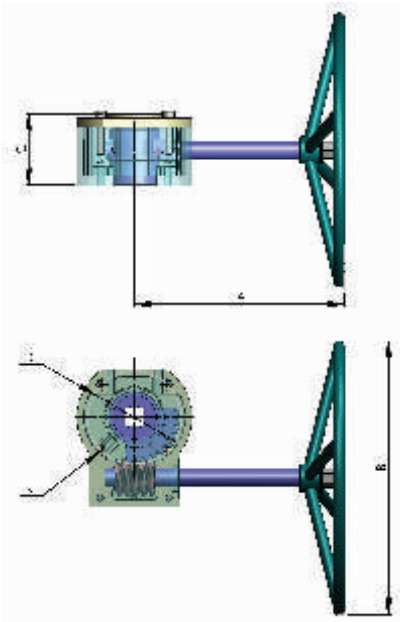

GEAR BOX SIZE

SIZE	TURNS TO CLOSE 90°	MAX OUTPUT TORQUEN (Nm)	A CENTER TO WHEEL END	B WHEEL DIA	C HIGHT OF GEAR BOX	D PCD OF MOUNTING RANGE	N NO. OF BOLTS
50MM(2")	6.25	125	145	200	60	50	4
100MM-150MM(4"-6")	6.25	125	145	200	60	70	4
200MM-350MM(8"-14")	8	500	240	300	75	102	4
400MM-450MM(16-18")	11.75	2000	255	400	85	140	4
500MM-600MM(20"-24")	11.25	4000	290	600	122	165	4

*The Dimension, Weight & Internal Design subject to the changes Made from Time to Time.

our associates



V.A. VALVES

Udyog Nagar, Gadaipur, Jalandhar-144 004, India
Tel : +91-181-2601540/41, 2600276/376 , Fax: +91-181-601741
E-mail: marketing@vk-utam.com, ankur.jain@vk-utam.com
www.vk-utam.com, www.indianvalves.in

Auth. Distributer

